

HEAT SEALER C3

C3
SYSTEM



This unit completes and extends the fresh product counter packaging options offered by the C1 SYSTEM and C2 SYSTEM, permitting use of a further series of containers and trays.

It provides great operating safety together with easy and efficient use and ensures sealed packaging for maximum product hygiene and protection. This is an indispensable unit for Operators wishing to upgrade and offer top-quality Counter Service to their customers.

TECHNICAL FEATURES

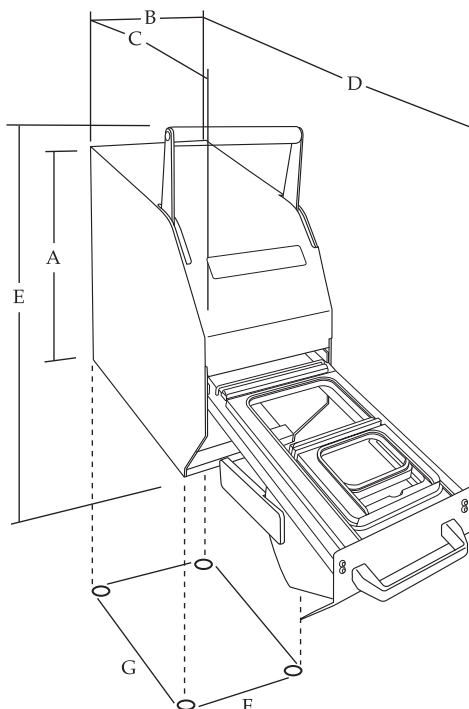

C3 MR - Total weight: 49,5 Kg approx. (without reel)

C3 M - Total weight: 55 Kg approx. (without reel)

Power supply: single-phase - earth

Power voltage: 220 V \pm 10%

Power frequency: 50 Hz

Installed power: 1000 W

Equivalent continuous sound radiation pressure under normal working conditions at a distance of 1 m is:

Leq(A) < 70 db(A)

Peak sound radiation pressure is: Lpe < 63 Pa

OVERALL DIMENSIONS:

A: 525mm

C: 505mm

E: 665mm

B: 275mm

D: 890mm

MINIMUM DIMENSIONS OF WORKTABLE:

F: 254mm

G: 376mm

Above reported data are indicative.

The manufacturer reserves the right to make any technical changes for the purpose of upgrading the machine, without notice.



COMPAC
COMMERCIALE PACKAGING

42024 Castelnovo di Sotto (RE) ITALY - Tel. +39. 0522.688.509 - Fax +39.0522.688.552
www.compac.it - e-mail: compac@tin.it

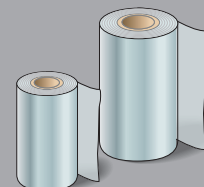

OPERATING SPECIFICATIONS

C3 SYSTEM

Film reel B2

Two reels permitting use of all containers and trays range.

Rotating internal drawer (only C3M model)

Film reel B1 (only C3M model)

Pull-out drawer for total operating safety, with sliding selector for choosing the desired size of Series G - L - M - X containers or trays.

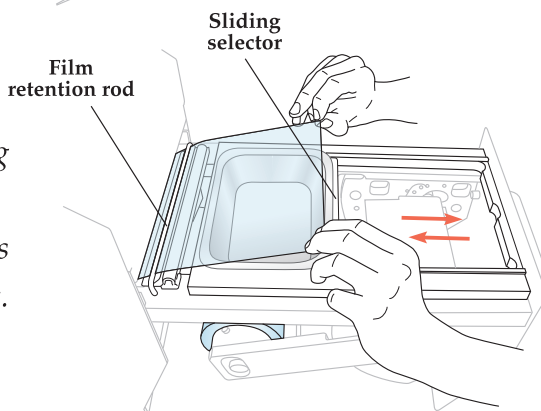

Sliding selector of internal drawer

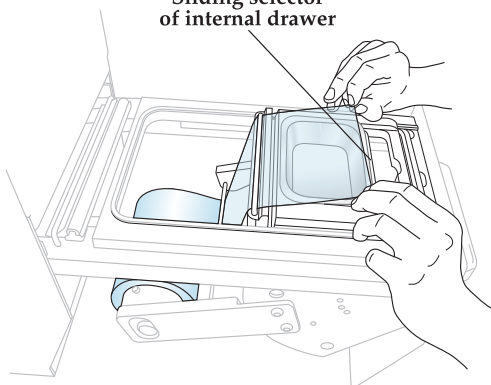

Rotating internal drawer for selecting the desired size of Series P1 - P2 containers.

It allows the sealing of containers P1 - P2 from reel avoiding the use of sheets.

Film sealing cycle with automatic cutting. To start the cycle, simply lower the lever as far as it will go and then release. It will then elevate automatically in a few seconds, after sealing operation has been completed.

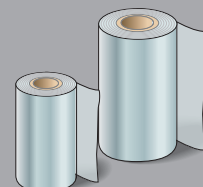
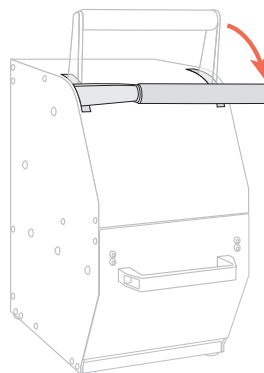

COMPAC
COMMERCIALE PACKAGING

42024 Castelnovo di Sotto (RE) ITALY - Tel. +39. 0522.688.509 - Fax +39.0522.688.552
www.compac.it - e-mail: compac@tin.it

